



CATERER DUO

SERIES: MOBILE PAVESI TRADITIONAL BRICK OVENS

Caterer Duo
with Coral Stucco



JOB NAME: _____

REFERENCE INVOICE #: _____

FUEL SOURCE (NO ELECTRICITY REQUIRED)



WOOD

FEATURES

The Caterer Duo mobile brick oven offers an agile option for catering at private or modest public events. Transformed from a Pavese oven from Modena, Italy to a now road-safe trailer. It features a decorative cast-iron arch opening allowing access to the hearth at 20.5" wide by 10.5" tall. Its sturdy aluminum frame reduces the towing weight, making it possible to tow with most mid-range SUVs and larger. Once stationed, the side stainless steel doors open up to create a secure countertop whilst doubling as doors for the ample storage space below. Choose from six different stucco colors.

STUCCO COLOR OPTIONS



CORAL

HEMP
GOLD

TERRA

DESERT
SUN

CADET

CHARCOAL

OVEN PRODUCTION



12" PIZZA
CAPACITY: 2



ROAST CHICKEN
CAPACITY: 3



BREAD LOAF
CAPACITY: 6



60 MINUTE
PREHEAT TIME



90 SECOND PIZZA
BAKE TIME



OVEN FLOOR
TEMPERATURE: 500°F - 1000°F

EXTERNAL LENGTH



1629 mm
64.13"

EXTERNAL WIDTH

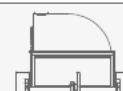

2184mm
86"

BAKING SURFACE



900 mm
35.4"

OVEN OPENING

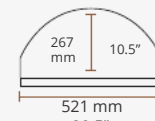

267 mm
10.5"
521 mm
20.5"

FIERO CASA
601 N Main St, Brewster, NY 10509
Email: info@fierocasa.com
www.fierocasa.com

844-OVEN-INC (844-683-6462)
Toll-free in USA
(Hablamos Español,
Falamos Português)

Oven Listed to: UL 2162-ULC/ORD C2162,
ANSI Z83.11-CSA 1.8, & NSF-4 for
Commercial Wood Fired and
Gas Fired Cooking Equipment



DOC#: CATDUO-08-2020

REVISED SPRING 2020. As products continue to improve, spec sheets may change without notice. Please call Fiero Casa for the latest specification sheet and for further details.

MADE IN ITALY



CATERER DUO

SERIES: MOBILE PAVESI TRADITIONAL BRICK OVENS

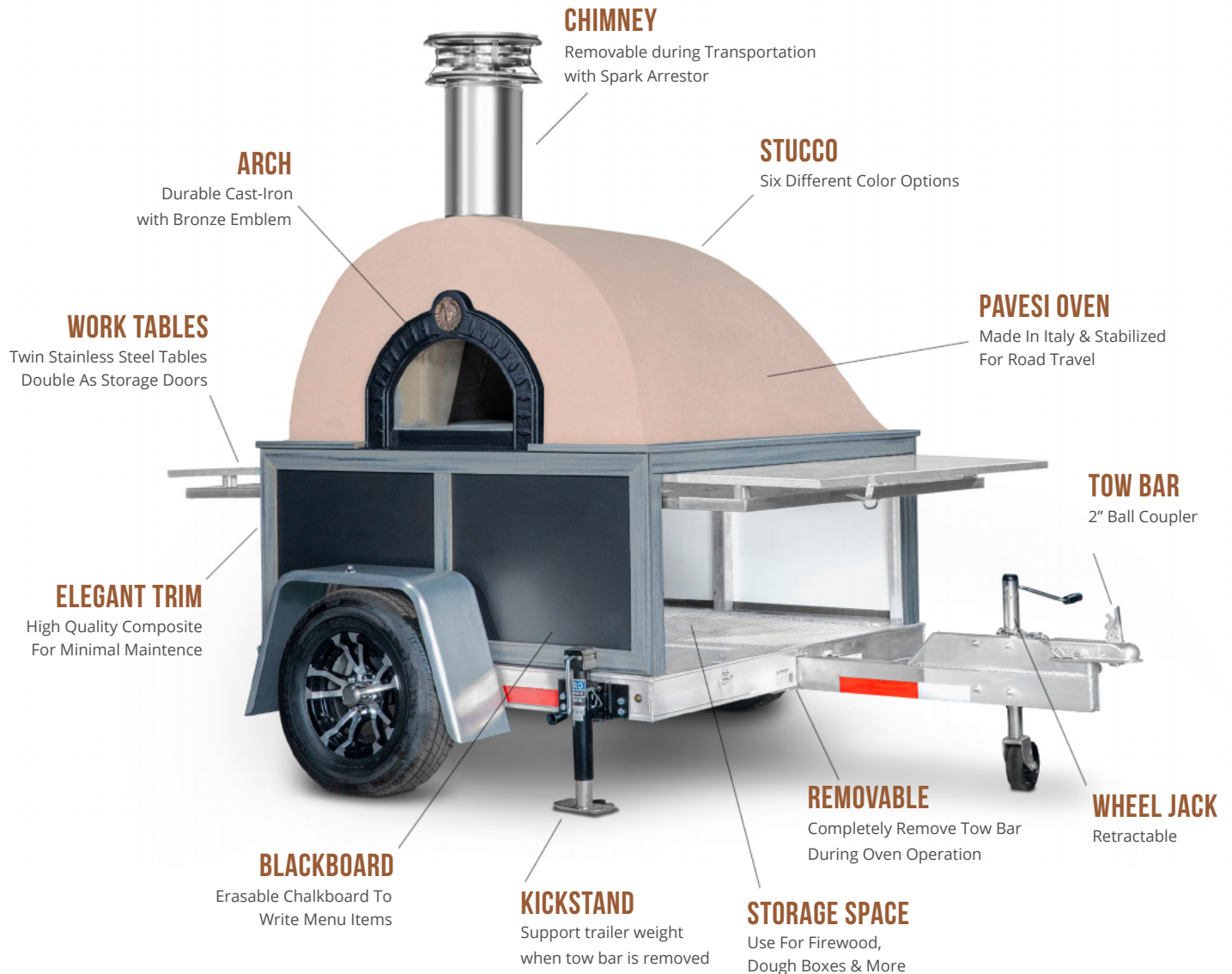

STORAGE & WORKSPACE



TWIN STAINLESS STEEL TABLES
53" x 20.75"



DOUGH & FIREWOOD STORAGE
57.00" x 57.00" x 19.25"

The twin stainless steel pop-up tables double as doors to unveil a roomy storage area below. Carry extra wood, dough boxes and other tools easily.

FREE-STANDING TRAILER MODE



REMOVABLE TOW BAR
For ease of access



TWIN KICKSTANDS
Support free-standing trailer weight

The trailer features a removable tow hitch bar and twin kickstands that allows the oven to stand without the support of the temporary wheel jack or vehicle.

FIERO CASA
601 N Main St, Brewster, NY 10509
Email: info@fierocasa.com
www.fierocasa.com

844-OVEN-INC (844-683-6462)
Toll-free in USA
(Hablamos Español,
Falamos Português)

Oven Listed to: UL 2162-ULC/ORD C2162,
ANSI Z83.11-CSA 1.8, & NSF-4 for
Commercial Wood Fired and
Gas Fired Cooking Equipment



DOC#: CATDUO-08-2020

REVISED SPRING 2020. As products continue to improve, spec sheets may change without notice. Please call Fiero Casa for the latest specification sheet and for further details.

MADE IN ITALY



CATERER DUO

SERIES: MOBILE PAVESI TRADITIONAL BRICK OVENS

DETAILED SPECS

We make every effort to provide accurate information regarding manufacturer's reported dimension information. Please note that due to the artisan nature of the manufacturing process, from time to time, product sizing and ship weight may vary slightly.

TOTAL WEIGHT UNLOADED	2,000 lbs
TONGUE WEIGHT UNLOADED	240 lbs
GROSS VEHICLE WEIGHT RATING	2,990 lbs
TOTAL LENGTH with TOW BAR	110"
EXTERNAL HEIGHT without CHIMNEY	72.75"

1 year limited warranty. See warranty document for details.

TOWING DETAILS



TOW CONNECTION
2" ball coupler



LIGHTING SIGNALS CONNECTION
4 pin flat trailer plug



BRAKING SYSTEM
None / Towing vehicle's

PLAN VIEW

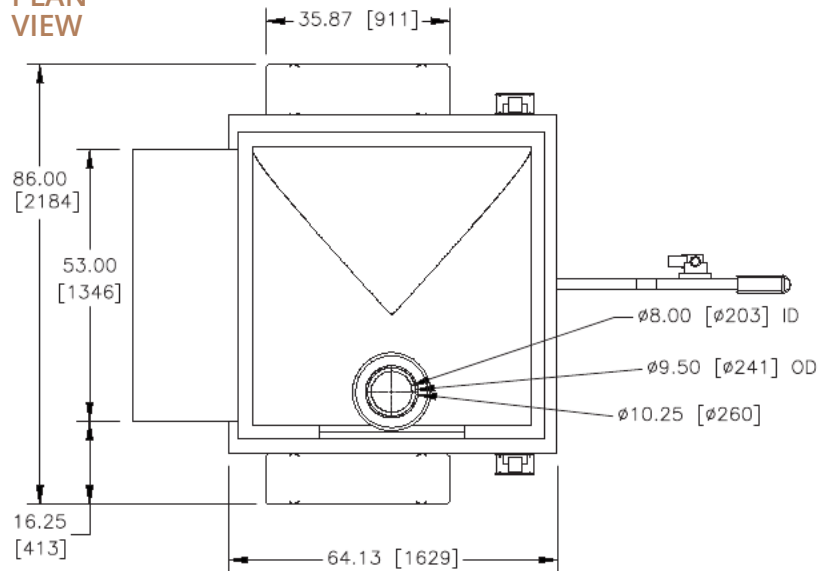

RIGHT ELEVATION

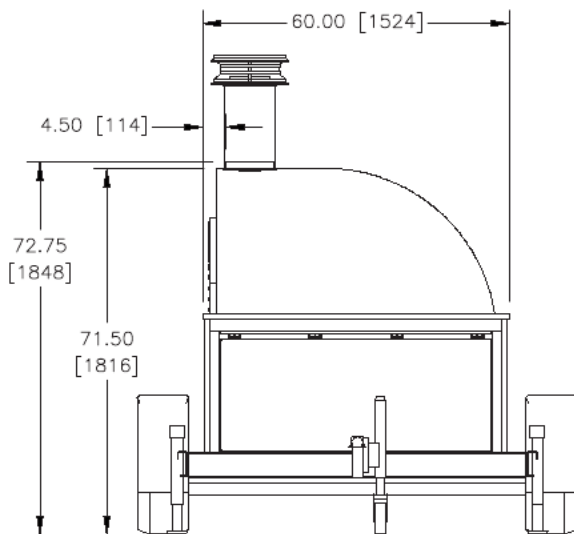

FRONT ELEVATION

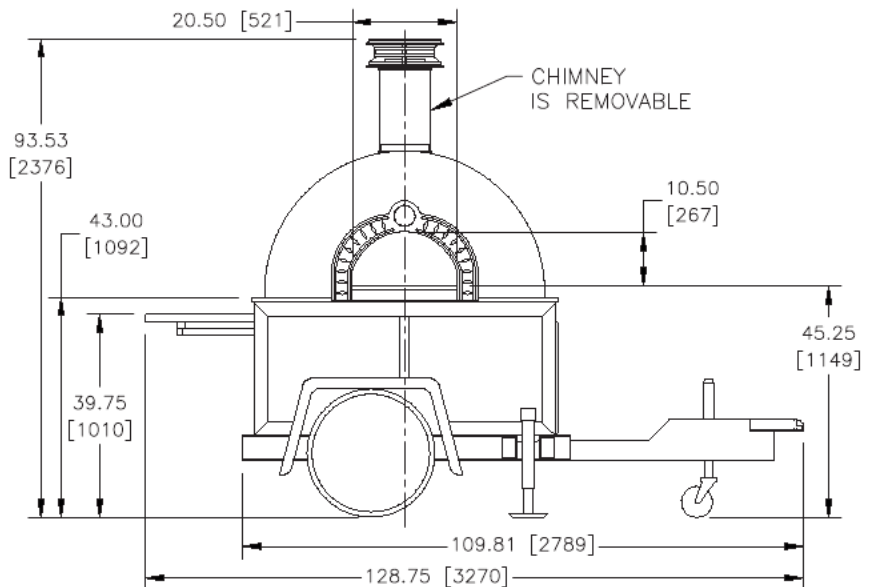

FIERO CASA
601 N Main St, Brewster, NY 10509
Email: info@fierocasa.com
www.fierocasa.com

844-OVEN-INC (844-683-6462)
Toll-free in USA
(Hablamos Español,
Falamos Português)

Oven Listed to: UL 2162-ULC/ORD C2162,
ANSI Z83.11-CSA 1.8, & NSF-4 for
Commercial Wood Fired and
Gas Fired Cooking Equipment

